

# Technical data sheet

## Support clamp for cables

Item number: 1488481



Support clamp for mounting cables. Open cable seat at side. Fastening through knocking onto steel girders.



St	Steel
ZL	Zinc slat

### Master data

Item number	1488481
Type	SCC 4-7,5 D5,5
Description 1	Beam clamp
Description 2	for cable, 4,5-5,5mm
Manufacturer	OBO
Dimension	4-7,5mm
Material	Steel
Surface	Zinc slat
Surface standard	
Smallest sales unit	100
Unit of quantity	Piece
Weight	0.5 kg
Weight unit	kg/100 pc.

# Technical data sheet

## Support clamp for cables

Item number: 1488481



### Dimensions

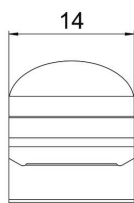
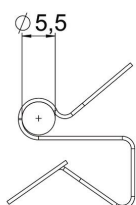

Length	14 mm
Width	14 mm
Height	16 mm
Maß W	14 mm

### Technical data

Connection type/component	Pipe/cable
Fastening type	Clamp
Flange thickness F max.	7.5 mm
Flange thickness F min.	4 mm
Pipe/cable diameter, max.	5 mm
Pipe/cable diameter, min.	4 mm
Hinge, adjustable	no
Hinged	no